

This Changed 5.5 Bolt pattern to 4.75 Chevy pattern.

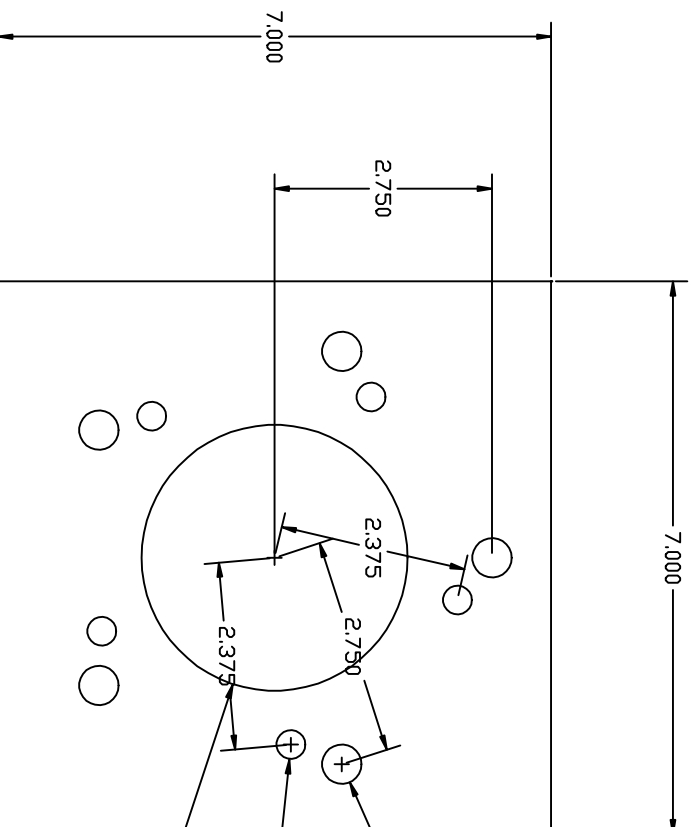

.500 holes with 2.75 Radius match original Truck bolt pattern.

.375 holes are new pattern 2.375 Radius to match 4.75" pattern chevy car wheels

Ø3.375
Hole Large enough
to clear axle flange

I cut plates from 10 or 12 Gauge material and laminated them onto the existing axle. Bolt plates to axle flange and drill through other holes with new bolt hole pattern. I make 2 set of plates, I set with $\frac{3}{16}$ diameter holes to start pattern then change over to $\frac{3}{8}$ hole plates. Use enough plates to keep drill bit straight. I drill the holes that recieve new studs by hand keeping drill stright into predrilled holes.

P.S. I do CAD/CAM for a lilving and cut parts using a LASER which gives me accurate parts. Could be done with water jet or a good CNC plasma with same results. If you have any questions just contact me.

Gary